

LYNDHURST ROAD SUBDIVISION - STAGE 8

**GREENSTONE LAND
DEVELOPMENT LTD
PROJECT NO. J4963
FOR AS-BUILT**

DRAWING SHEET LIST		
SHEET NO.	SHEET NAME	REV
AB-000	COVER	
AB-001	AS-BUILT CONTOUR PLAN	1
AB-002	ROADING AND ROAD FEATURES AS-BUILT PLAN	1
AB-003	STORMWATER AS-BUILT PLAN	1
AB-004	STORMWATER LONG SECTION AS-BUILT PLAN	1
AB-005	SEWER AS-BUILT PLAN	1
AB-006	SEWER LONG SECTION AS-BUILT PLAN	1
AB-007	WATER AS-BUILT PLAN	1





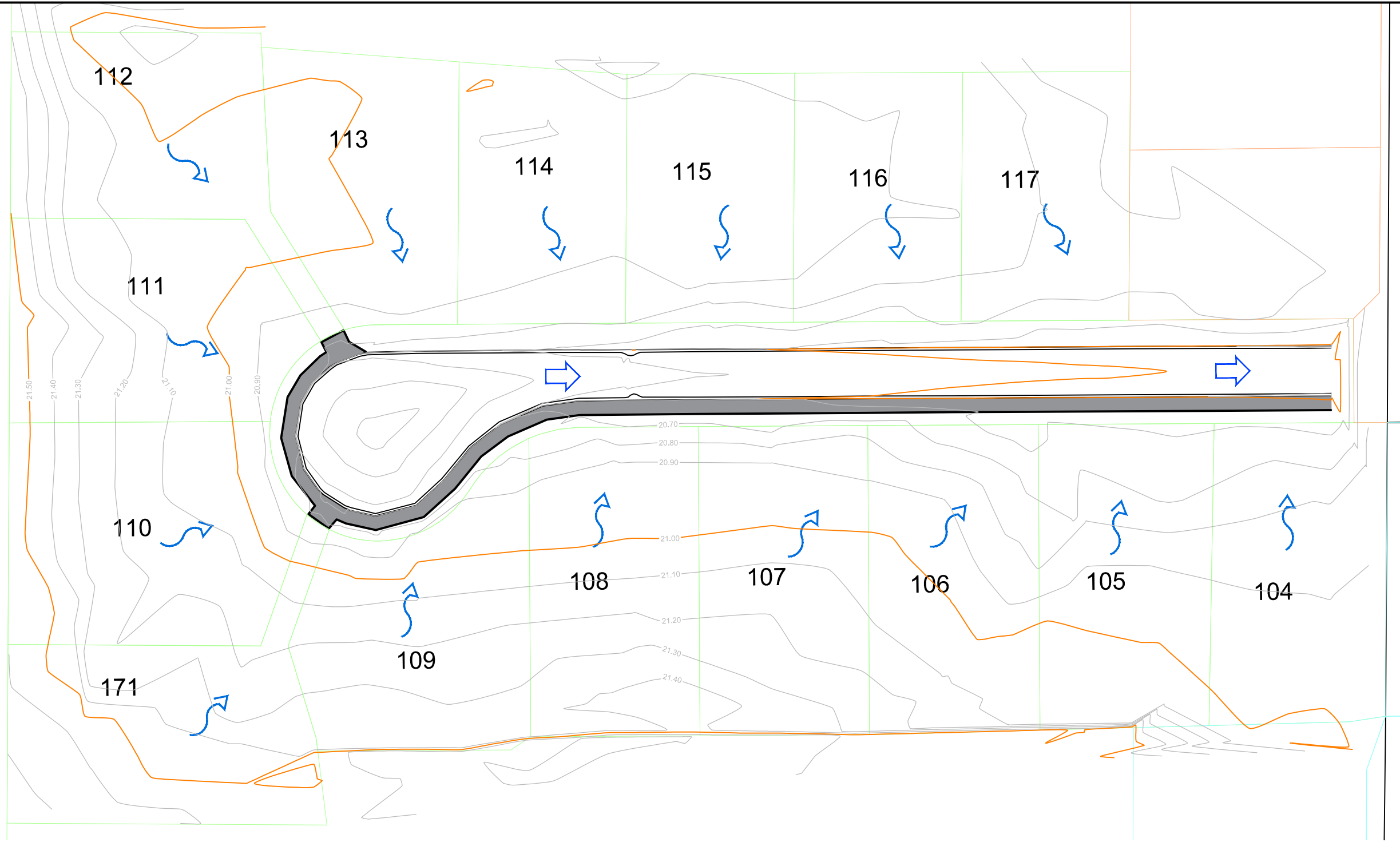

Lot 218

HDC Reserve



NOTES: ALL LOTS ARE FORMED TO A MINIMUM OF RL:21.00

KEY:

-  - PRIMARY FLOW PATH
-  - PRIMARY FLOW PATH
-  - MAJOR CONTOURS
-  - MINOR CONTOURS

SAFETY IN DESIGN			
ALL REASONABLY PRACTICABLE STEPS HAVE BEEN TAKEN TO ENSURE SAFETY IN DESIGN HAS BEEN CONSIDERED WITHIN STRATA GROUPS SCOPE OF WORK FOR THIS DESIGN IN ACCORDANCE WITH IPENZ PRACTICE NOTE 07 'DESIGN FOR SAFETY IN BUILDINGS AND OTHER STRUCTURES (JULY 2006)'. IT REMAINS THE RESPONSIBILITY OF THE OWNER AND/OR OPERATOR TO ENSURE APPROPRIATE PRACTICES ARE IN PLACE TO PROTECT THE SAFETY OF THE WORKERS AND THE PUBLIC IN THE OPERATION OF THE FACILITY.			
1	FOR ASBUILT	29/07/2019	LZ
REV	REASON FOR ISSUE	DATE	BY

REV	REASON FOR ISSUE	DATE	BY
1	FOR ASBUILT	29/07/2019	LZ

THE CONTRACTOR IS TO BE AWARE OF ALL INSPECTIONS TO BE MADE BY THE ENGINEER AS A REQUIREMENT OF THE PRODUCER STATEMENT PS4 CONSTRUCTION REVIEW DOCUMENTATION. THE ENGINEER WILL REQUIRE 24 HOURS PRIOR NOTIFICATION WHEN ALL STRUCTURAL ELEMENTS ARE READY TO BE INSPECTED.

stratagroup
CONSULTING ENGINEERS

P 06 876 7646
F 06 876 7645
www.stratagroup.net.nz

PO BOX 758
Business HQ
1/308 Queen Street East
Hastings, New Zealand

Structural Fire Civil Project Management

CLIENT:

Greenstone
LAND DEVELOPMENTS

PROJECT: LYNDHURST ARBUCKLE
SUBDIVISION - STAGE 8
LYNDHURST ROAD
HASTINGS

TITLE: AS-BUILT
CONTOUR PLAN

This drawing and its contents are the property of Strata Group Consulting Engineers Ltd. Any unauthorized employment or reproduction in full or part is forbidden.

DESIGNED DJ	0	2.5	5	10	15
DRAWN MC	Full Size 1:250 ; Half Size 1:500				
CHECKED DJ	Scale (m)				
DATE 6/8/19	PROJECT NO.: J4693	SHEET: AB001	REVISION: 1		



Lot 218

HDC Reserve

Lot 222

112

113

114

115

116

117

111

NEW VEHICLE CROSSING
IN ACCORDANCE WITH HDC

TREE

TREE

TOK=20.66m

TREE

TREE

TREE

TOK=20.49m

LOK=20.4m

LOK=20.4m

TOK=20.82m

LOK=20.73m

110

NEW VEHICLE CROSSING
IN ACCORDANCE WITH HDC

1.41m

1.62m

TOK=20.64m

1.45m

1.61m

TOK=20.49m

109

108

107

106

105

104

171

SAFETY IN DESIGN			
ALL REASONABLY PRACTICABLE STEPS HAVE BEEN TAKEN TO ENSURE SAFETY IN DESIGN HAS BEEN CONSIDERED WITHIN STRATA GROUPS SCOPE OF WORK FOR THIS DESIGN IN ACCORDANCE WITH IPENZ PRACTICE NOTE 07 'DESIGN FOR SAFETY IN BUILDINGS AND OTHER STRUCTURES (JULY 2006)'. IT REMAINS THE RESPONSIBILITY OF THE OWNER AND/OR OPERATOR TO ENSURE APPROPRIATE PRACTICES ARE IN PLACE TO PROTECT THE SAFETY OF THE WORKERS AND THE PUBLIC IN THE OPERATION OF THE FACILITY.			
1	FOR ASBUILT	29/07/2019	LZ
REV	REASON FOR ISSUE	DATE	BY

THE CONTRACTOR IS TO BE AWARE OF ALL INSPECTIONS TO BE MADE BY THE ENGINEER AS A REQUIREMENT OF THE PRODUCER STATEMENT PS4 CONSTRUCTION REVIEW DOCUMENTATION. THE ENGINEER WILL REQUIRE 24 HOURS PRIOR NOTIFICATION WHEN ALL STRUCTURAL ELEMENTS ARE READY TO BE INSPECTED.

stratagroup
CONSULTING ENGINEERS

P 06 876 7646
F 06 876 7645
www.stratagroup.net.nz

PO BOX 758
Business HQ
1/308 Queen Street East
Hastings, New Zealand

Structural Fire Civil Project Management

CLIENT:

Greenstone
LAND DEVELOPMENTS

PROJECT:

LYNDHURST ARBUCKLE
SUBDIVISION - STAGE 8
LYNDHURST ROAD
HASTINGS

TITLE:

ROADING
ASBULT PLAN

This drawing and its contents are the property of Strata Group Consulting Engineers Ltd. Any unauthorized employment or reproduction in full or part is forbidden.

ASBULT INFORMATION SUPPLIED BY ZORN SURVEYING LTD

DESIGNED DJ	0 2.5 5 10 15
DRAWN EM	Full Size 1:250 ; Half Size 1:500
CHECKED DJ	Scale (m)
DATE MAY 18	
PROJECT NO.:	SHEET: REVISION:
J4693	AB002 1



Lot 218
HDC Reserve

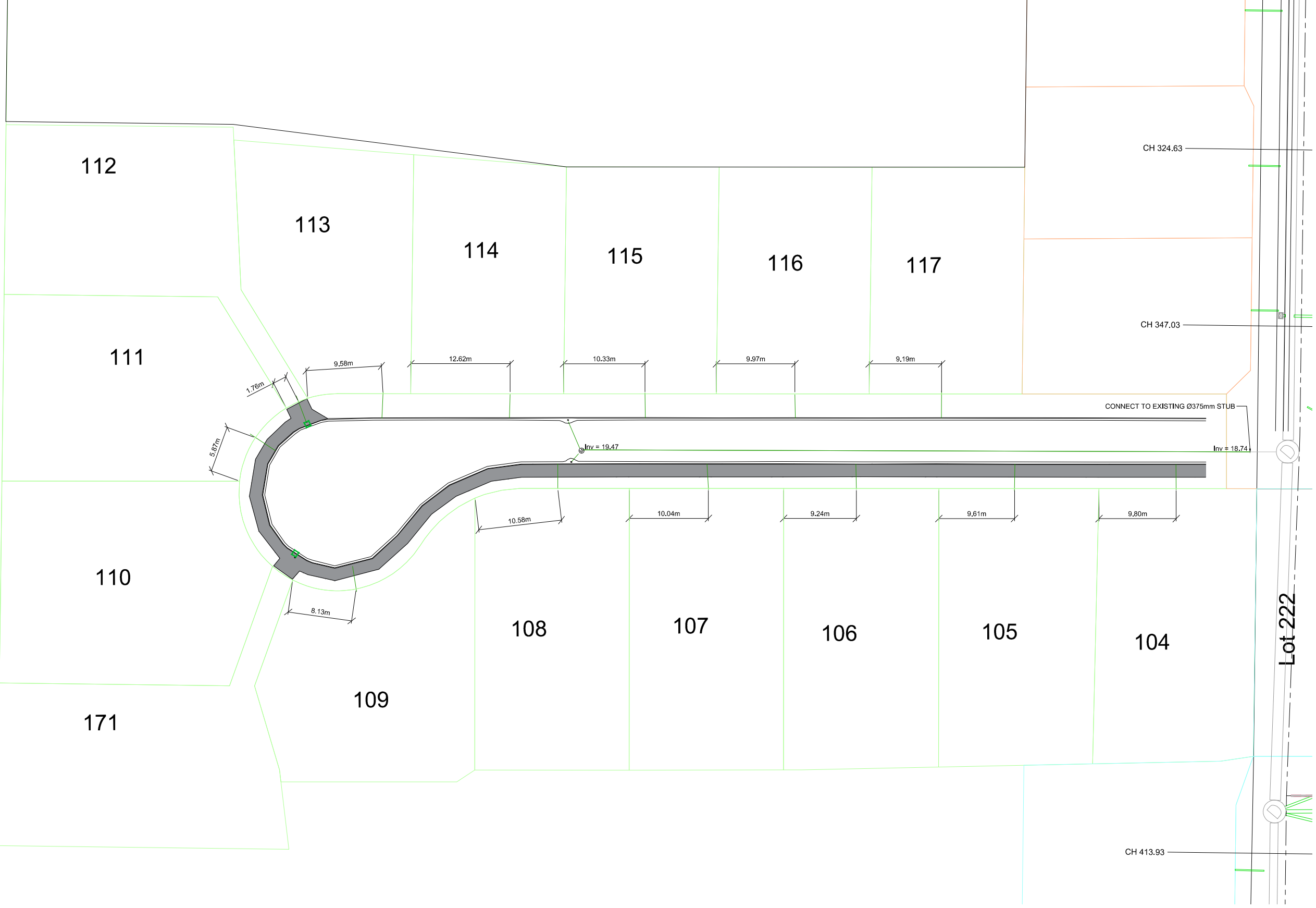

DRAIN LAYER: DRAINWAYS
 DATE LAID: XX/XXXX - XX/XXXX
 ASBULT INFORMATION SUPPLIED BY ZORN SURVEYING LTD

SAFETY IN DESIGN

ALL REASONABLY PRACTICABLE STEPS HAVE BEEN TAKEN TO ENSURE SAFETY IN DESIGN HAS BEEN CONSIDERED WITHIN STRATA GROUPS SCOPE OF WORK FOR THIS DESIGN IN ACCORDANCE WITH IPENZ PRACTICE NOTE 07 'DESIGN FOR SAFETY IN BUILDINGS AND OTHER STRUCTURES (JULY 2006)'. IT REMAINS THE RESPONSIBILITY OF THE OWNER AND/OR OPERATOR TO ENSURE APPROPRIATE PRACTICES ARE IN PLACE TO PROTECT THE SAFETY OF THE WORKERS AND THE PUBLIC IN THE OPERATION OF THE FACILITY.

REV	REASON FOR ISSUE	DATE	BY
1	FOR ASBULT	29/07/2019	LZ

REV	REASON FOR ISSUE	DATE	BY
1	FOR ASBULT	29/07/2019	LZ

THE CONTRACTOR IS TO BE AWARE OF ALL INSPECTIONS TO BE MADE BY THE ENGINEER AS A REQUIREMENT OF THE PRODUCER STATEMENT PSA CONSTRUCTION REVIEW DOCUMENTATION. THE ENGINEER WILL REQUIRE 24 HOURS PRIOR NOTIFICATION WHEN ALL STRUCTURAL ELEMENTS ARE READY TO BE INSPECTED.

stratagroup
 CONSULTING ENGINEERS

P 06 876 7646
 F 06 876 7645
 www.stratagroup.net.nz

PO BOX 758
 Business HQ
 1/308 Queen Street East
 Hastings, New Zealand

Structural Fire Civil Project Management

CLIENT:

Greenstone
 LAND DEVELOPMENTS

PROJECT: LYNDHURST ARBUCKLE
 SUBDIVISION - STAGE 8
 LYNDHURST ROAD
 HASTINGS

TITLE: STORMWATER
 ASBULT PLAN

This drawing and its contents are the property of Strata Group Consulting Engineers Ltd. Any unauthorized employment or reproduction in full or part is forbidden.

DESIGNED DJ	0	2.5	5	10	15
DRAWN EM	Full Size 1:250 ; Half Size 1:500				
CHECKED DJ	Scale (m)				
DATE MAY 18					
PROJECT NO.:	J4693	SHEET:	AB003	REVISION:	1

PIPE DETAILS

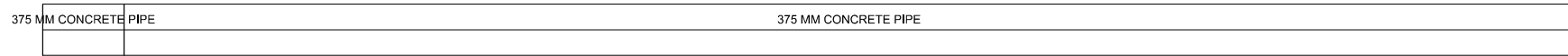

SCALE: 1:50H, 1:50V
 DATUM: 16.00
 GRADE (%)
 GRADE (1 IN)

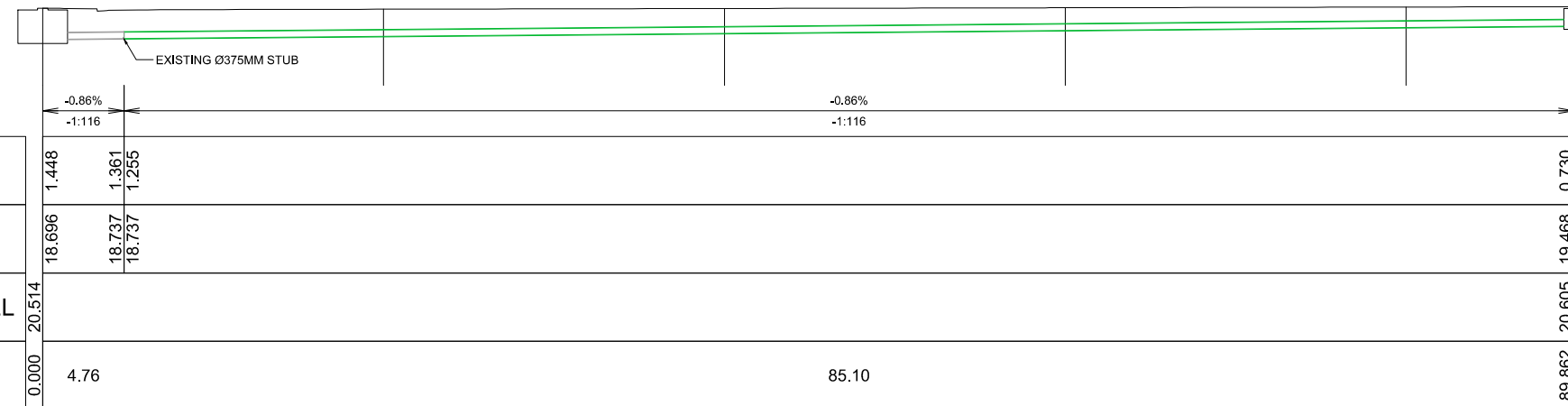

COVER	1.448	1.361	1.255	0.730
INVERT LEVEL	18.696	18.737	18.737	19.468
FINISHED SURFACE LEVEL	20.514			20.605
CHAINAGE	0.000	4.76	85.10	89.862

STORMWATER STAGE 8 LONG SECTION

DRAIN LAYER: DRAINWAYS
 DATE LAID: XX/XXXX - XX/XXXX
 ASBUILT INFORMATION SUPPLIED BY ZORN SURVEYING LTD

SAFETY IN DESIGN			
ALL REASONABLY PRACTICABLE STEPS HAVE BEEN TAKEN TO ENSURE SAFETY IN DESIGN HAS BEEN CONSIDERED WITHIN STRATA GROUPS SCOPE OF WORK FOR THIS DESIGN IN ACCORDANCE WITH IPENZ PRACTICE NOTE 07 'DESIGN FOR SAFETY IN BUILDINGS AND OTHER STRUCTURES (JULY 2006)'. IT REMAINS THE RESPONSIBILITY OF THE OWNER AND/OR OPERATOR TO ENSURE APPROPRIATE PRACTICES ARE IN PLACE TO PROTECT THE SAFETY OF THE WORKERS AND THE PUBLIC IN THE OPERATION OF THE FACILITY.			
1	FOR ASBUILT	29/07/2019	LZ
REV	REASON FOR ISSUE	DATE	BY

THE CONTRACTOR IS TO BE AWARE OF ALL INSPECTIONS TO BE MADE BY THE ENGINEER AS A REQUIREMENT OF THE PRODUCER STATEMENT PS4 CONSTRUCTION REVIEW DOCUMENTATION. THE ENGINEER WILL REQUIRE 24 HOURS PRIOR NOTIFICATION WHEN ALL STRUCTURAL ELEMENTS ARE READY TO BE INSPECTED.			
---	--	--	--

stratagroup
 CONSULTING ENGINEERS
 P 06 876 7646
 F 06 876 7645
 www.stratagroup.net.nz
 PO BOX 758
 Business HQ
 1/308 Queen Street East
 Hastings, New Zealand
 Structural Fire Civil Project Management



CLIENT:
 PROJECT: LYNDHURST ARBUCKLE SUBDIVISION - STAGE 8
 LYNDHURST ROAD
 HASTINGS

TITLE: STORMWATER LONG SECTION ASBUILT PLAN

DESIGNED DJ	0	2	4	8	12
DRAWN EM	Full Size 1:200 ; Half Size 1:400				
CHECKED DJ	Scale (m)				
DATE MAY 18	PROJECT NO.: J4693	SHEET: AB004	REVISION: 1		

This drawing and its contents are the property of Strata Group Consulting Engineers Ltd. Any unauthorized employment or reproduction in full or part is forbidden.



Lot 218

HDC Reserve

112

113

114

115

116

117

111

110

171

109

108

107

106

105

104

Lot 222

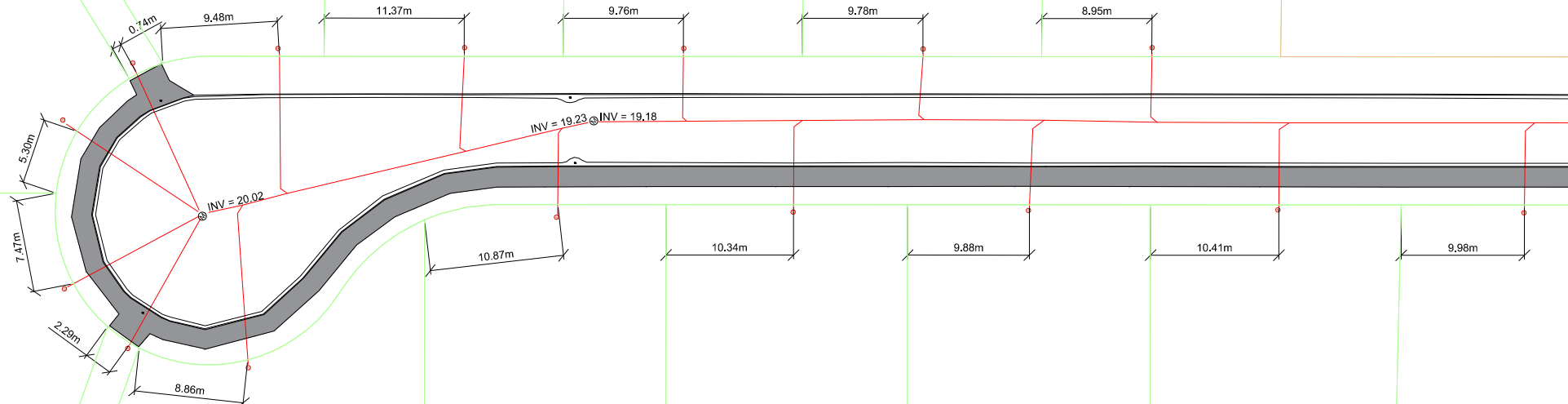

EXISTING Ø150MM STUB

DRAIN LAYER: DRAINWAYS
 DATE LAID: XX/XXXX - XX/XXXX
 ASBULT INFORMATION SUPPLIED BY ZORN SURVEYING LTD

SAFETY IN DESIGN			
ALL REASONABLY PRACTICABLE STEPS HAVE BEEN TAKEN TO ENSURE SAFETY IN DESIGN HAS BEEN CONSIDERED WITHIN STRATA GROUPS SCOPE OF WORK FOR THIS DESIGN IN ACCORDANCE WITH IPENZ PRACTICE NOTE 07 "DESIGN FOR SAFETY IN BUILDINGS AND OTHER STRUCTURES (JULY 2006)". IT REMAINS THE RESPONSIBILITY OF THE OWNER AND/OR OPERATOR TO ENSURE APPROPRIATE PRACTICES ARE IN PLACE TO PROTECT THE SAFETY OF THE WORKERS AND THE PUBLIC IN THE OPERATION OF THE FACILITY.			
1	FOR ASBULT	29/07/2019	LZ
REV	REASON FOR ISSUE	DATE	BY

THE CONTRACTOR IS TO BE AWARE OF ALL INSPECTIONS TO BE MADE BY THE ENGINEER AS A REQUIREMENT OF THE PRODUCER STATEMENT PSA CONSTRUCTION REVIEW DOCUMENTATION. THE ENGINEER WILL REQUIRE 24 HOURS PRIOR NOTIFICATION WHEN ALL STRUCTURAL ELEMENTS ARE READY TO BE INSPECTED.

stratagroup
 CONSULTING ENGINEERS
 P 06 876 7646
 F 06 876 7645
 www.stratagroup.net.nz
 PO BOX 758
 Business HQ
 1/308 Queen Street East
 Hastings, New Zealand
 Structural Fire Civil Project Management

CLIENT:

Greenstone
 LAND DEVELOPMENTS

PROJECT:
 LYNDBURST ARBUCKLE
 SUBDIVISION - STAGE 8
 LYNDBURST ROAD
 HASTINGS

TITLE:
 SEWER
 ASBULT PLAN

This drawing and its contents are the property of Strata Group Consulting Engineers Ltd. Any unauthorized employment or reproduction in full or part is forbidden.

DESIGNED DJ	0 2.5 5 10 15
DRAWN EM	Full Size 1:250 ; Half Size 1:500
CHECKED DJ	Scale (m)
DATE MAY 18	
PROJECT NO.: J4693	SHEET: AB005
	REVISION: 1



SEWER STAGE 8 LONG SECTION

DRAIN LAYER: DRAINWAYS
DATE LAID: XX/XXXX - XX/XXXX
ASBUILT INFORMATION SUPPLIED BY ZORN SURVEYING LTD

REV	REASON FOR ISSUE	DATE	BY
1	FOR ASBUILT	29/07/2019	LZ

THE CONTRACTOR IS TO BE AWARE OF ALL INSPECTIONS TO BE MADE BY THE ENGINEER AS A REQUIREMENT OF THE PRODUCER STATEMENT PS4 CONSTRUCTION REVIEW DOCUMENTATION. THE ENGINEER WILL REQUIRE 24 HOURS PRIOR NOTIFICATION WHEN ALL STRUCTURAL ELEMENTS ARE READY TO BE INSPECTED.

stratagroup
CONSULTING ENGINEERS

P 06 876 7646
F 06 876 7645
www.stratagroup.net.nz

PO BOX 758
Business HQ
1/308 Queen Street East
Hastings, New Zealand

Structural Fire Civil Project Management

CLIENT:

Greenstone
LAND DEVELOPMENTS

PROJECT:

LYNDHURST ARBUCKLE
SUBDIVISION - STAGE 8
LYNDHURST ROAD
HASTINGS

TITLE:

SEWER
LONG SECTION
ASBUILT PLAN

This drawing and its contents are the property of Strata Group Consulting Engineers Ltd. Any unauthorized employment or reproduction in full or part is forbidden.

DESIGNED DJ	0	2	4	8	12
DRAWN EM	Full Size 1:200 ; Half Size 1:400				
CHECKED DJ	Scale (m)				
DATE MAY 18	PROJECT NO.: J4693	SHEET: AB006	REVISION: 1		



Lot 218

HDC Reserve

Lot 222

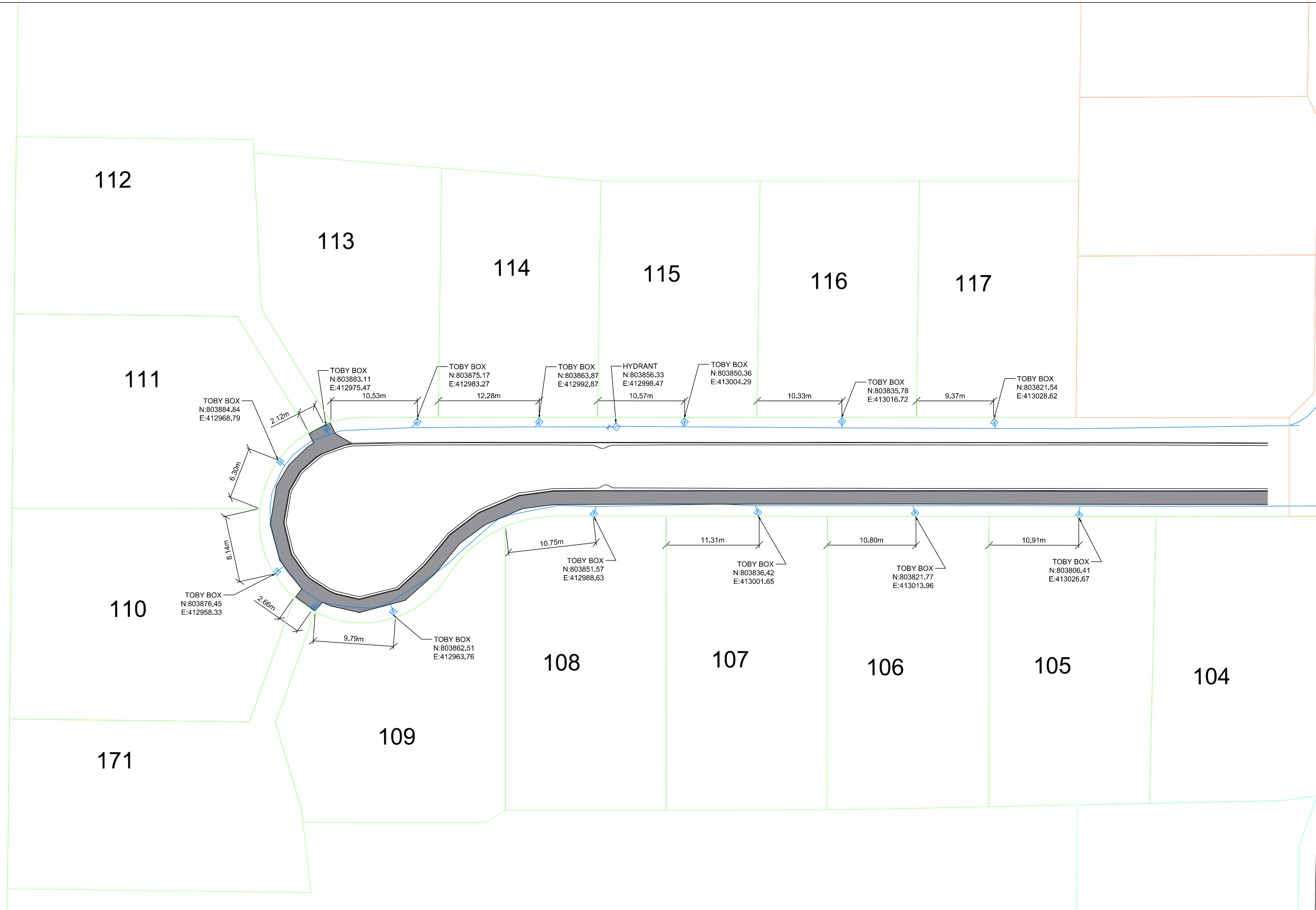

LEGEND:

- 150mm PVC PIPE
- - - - - 63mm PE PIPE
- W TOBY BOX
- X VALVE
- H FIRE HYDRANT

DRAIN LAYER: DRAINWAYS
 DATE LAID: XX/XXXX - XX/XXXX
 ASBUILT INFORMATION SUPPLIED BY ZORN SURVEYING LTD

DESIGNED	DJ	<p>Full Size 1:250 ; Half Size 1:500 Scale (m)</p>			
DRAWN	EM				
CHECKED	DJ				
DATE	MAY 18				
PROJECT NO.:	J4693	SHEET:	AB007	REVISION:	1

SAFETY IN DESIGN			
ALL REASONABLY PRACTICABLE STEPS HAVE BEEN TAKEN TO ENSURE SAFETY IN DESIGN HAS BEEN CONSIDERED WITHIN STRATA GROUPS SCOPE OF WORK FOR THIS DESIGN IN ACCORDANCE WITH IPENZ PRACTICE NOTE 07 "DESIGN FOR SAFETY IN BUILDINGS AND OTHER STRUCTURES (JULY 2006)". IT REMAINS THE RESPONSIBILITY OF THE OWNER AND/OR OPERATOR TO ENSURE APPROPRIATE PRACTICES ARE IN PLACE TO PROTECT THE SAFETY OF THE WORKERS AND THE PUBLIC IN THE OPERATION OF THE FACILITY.			
1	FOR ASBUILT	29/07/2019	LZ
REV	REASON FOR ISSUE	DATE	BY

THE CONTRACTOR IS TO BE AWARE OF ALL INSPECTIONS TO BE MADE BY THE ENGINEER AS A REQUIREMENT OF THE PRODUCER STATEMENT PSA CONSTRUCTION REVIEW DOCUMENTATION. THE ENGINEER WILL REQUIRE 24 HOURS PRIOR NOTIFICATION WHEN ALL STRUCTURAL ELEMENTS ARE READY TO BE INSPECTED.			
---	--	--	--

stratagroup
 CONSULTING ENGINEERS
 P 06 876 7646
 F 06 876 7645
 www.stratagroup.net.nz
 PO BOX 758
 Business HQ
 1/308 Queen Street East
 Hastings, New Zealand

CLIENT:
Greenstone
 LAND DEVELOPMENTS

PROJECT:
 LYNDBURST ARBUCKLE
 SUBDIVISION - STAGE 8
 LYNDBURST ROAD
 HASTINGS

TITLE:
 WATER
 ASBUILT PLAN

This drawing and its contents are the property of Strata Group Consulting Engineers Ltd. Any unauthorized employment or reproduction in full or part is forbidden.