

REV	REASON FOR ISSUE	DATE	BY

SAFETY IN DESIGN
 THE ENGINEER HAS CONSIDERED THE SAFETY OF THE WORKERS AND THE PUBLIC IN THE OPERATION OF THE FACILITY.
 THE SAFETY OF THE WORKERS AND THE PUBLIC IN THE OPERATION OF THE FACILITY IS THE RESPONSIBILITY OF THE DESIGNER AND THE USER.
 THE ENGINEER HAS CONSIDERED THE SAFETY OF THE WORKERS AND THE PUBLIC IN THE OPERATION OF THE FACILITY.
 THE SAFETY OF THE WORKERS AND THE PUBLIC IN THE OPERATION OF THE FACILITY IS THE RESPONSIBILITY OF THE DESIGNER AND THE USER.

THE CONTRACTOR IS TO BE AWARE OF ALL
 INSPECTIONS TO BE MADE BY THE ENGINEER AS
 A REQUIREMENT OF THE PRODUCTION STATEMENT
 OF WORK. THE CONTRACTOR IS TO BE AWARE OF ALL
 INSPECTIONS TO BE MADE BY THE ENGINEER AS
 A REQUIREMENT OF THE PRODUCTION STATEMENT
 OF WORK. THE CONTRACTOR IS TO BE AWARE OF ALL
 INSPECTIONS TO BE MADE BY THE ENGINEER AS
 A REQUIREMENT OF THE PRODUCTION STATEMENT
 OF WORK.

CLIENT: GREENSTONE LAND DEVELOPMENT LTD

PROJECT: LYNDRHURST ARBUCKLE SUBDIVISION

TITLE: WASTEWATER ASBUILT PLAN STAGE 4

DESIGNED BY: J4293

CHECKED BY: DATE: 20/02/18

PROJECT NO.: J4293

SHEET: C005

REVISION:

The drawings are the property of the design firm. All rights reserved. No part of this drawing may be reproduced in any form or by any means without the prior written consent of the design firm.

stratagroup
 CONSULTING ENGINEERS

10/00 Owen Street East
 Stouffville, ON L4R 1A3
 P: 905 768 7668
 F: 905 768 7669
 Email: info@stratagroup.ca
 Website: www.stratagroup.ca

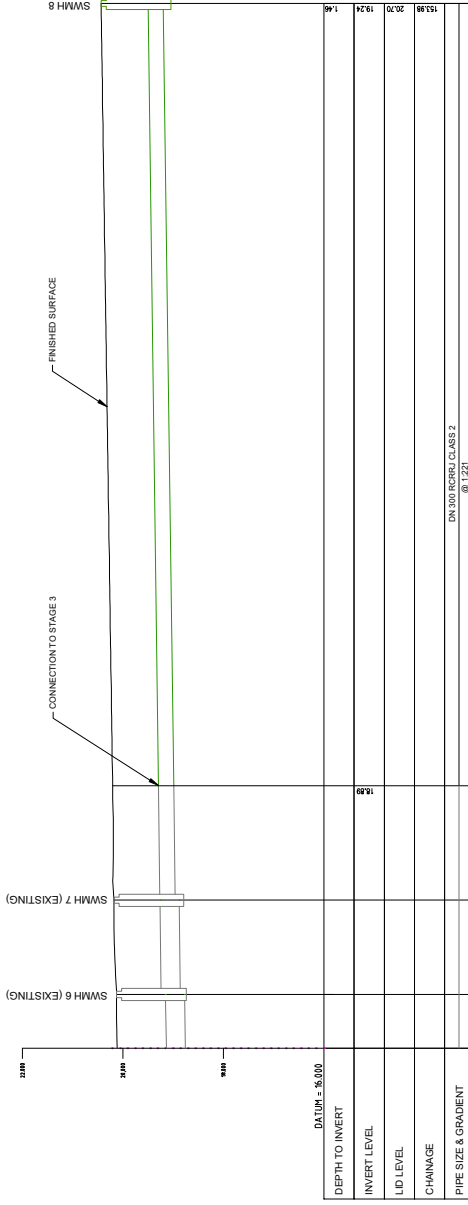

LONGITUDINAL SECTION
HORIZONTAL SCALE:1:250 VERTICAL SCALE 1:50

DEPTH TO INVERT	8.00
INVERT LEVEL	19.24
LID LEVEL	
CHARGE	
PIPE SIZE & GRADIENT	DN 300 RCRUL CLASS 2 @ 1251

SAFETY IN DESIGN
 ALL REASONABLY FORESEEABLE STEPS HAVE BEEN TAKEN TO ENSURE SAFETY IN DESIGN HAS BEEN CONSIDERED WITHIN STRATA PRACTICE NOTE OF DESIGN FOR SAFETY IN BUILDINGS AND PRACTICES ARE IN PLACE TO PROTECT THE SAFETY OF THE WORKERS AND THE PUBLIC IN THE OPERATION OF THE FACILITY.

REV	REASON FOR ISSUE	DATE	BY
1 <td>FOR CLARITY <td>03/20/21 <td>RB </td></td></td>	FOR CLARITY <td>03/20/21 <td>RB </td></td>	03/20/21 <td>RB </td>	RB

THE CONTRACTOR IS TO BE AWARE OF ALL INSPECTIONS TO BE MADE BY THE ENGINEER AS PER CONSTRUCTION REVIEW DOCUMENTATION AND ALL TO BE COMPLETED WITHIN THE NOTIFICATION WHEN ALL STRUCTURAL ELEMENTS ARE READY TO BE INSPECTED.

stratagroup
 CONSULTING ENGINEERS
 P 06 8097698
 F 06 8097698
 www.stratagroup.co.nz
 Stratagroup Ltd
 1000 Ocean View Street
 Business 102
 Auckland
 New Zealand
 Civil Project Management

CLIENT
GREENSTONE LAND DEVELOPMENTS LTD

PROJECT
LYNDHURST ARBUCKLE

TITLE
STORMWATER LONGITUDINAL SECTIONS AS BUILT

DESIGNED BY DWAYNE RB	CHECKED BY DWAYNE RB	DATE/NO/2021/18	PROJECT NO. J4293	SHEET C007	REVISION 1
--------------------------	-------------------------	-----------------	----------------------	---------------	---------------

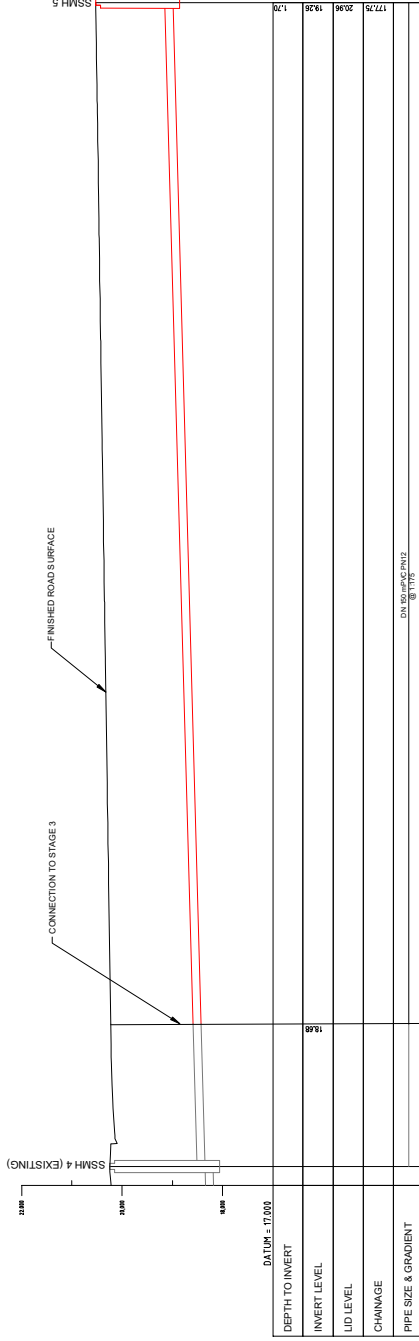

LONGITUDINAL SECTION
HORIZONTAL SCALE 1:250 VERTICAL SCALE 1:50

SAFETY IN DESIGN
 ALL DESIGN PRACTICES HAVE BEEN TAKEN TO
 ENSURE SAFETY IN DESIGN HAS BEEN CONSIDERED WITHIN STRATA
 PRACTICE NOTE OF DESIGN FOR SAFETY IN BUILDINGS AND
 THE OWNER AND/OR OPERATOR TO ENSURE APPROPRIATE
 PRACTICES ARE IN PLACE TO PROTECT THE SAFETY OF THE
 WORKERS AND THE PUBLIC IN THE OPERATION OF THE FACILITY.

REV	REASON FOR ISSUE	DATE	BY
1	FOR CLARITY	03/20/21	RB

THE CONTRACTOR IS TO BE AWARE OF ALL
 INSPECTIONS TO BE MADE BY THE ENGINEER AS
 PER CONSTRUCTION REVIEW DOCUMENTATION
 AND TO BE ADVISED OF ANY DEFICIENCIES IN
 NOTIFICATION WHEN ALL STRUCTURAL
 ELEMENTS ARE READY TO BE INSPECTED.

stratagroup
 CONSULTING ENGINEERS
 P 08 8077688
 www.stratagroup.nz
 1000 Ocean View Drive
 Auckland 1010
 Civil Project Management

CLIENT
**GREENSTONE LAND
 DEVELOPMENTS LTD**

PROJECT
LYNDHURST ARBUCKLE

TITLE
**WASTEWATER
 LONGITUDINAL SECTIONS
 AS BUILT**

DESIGNED BY DJ	CHECKED BY RB	DATE 02/02/21	PROJECT NO. J4293	SHEET C008	REVISION 1
-------------------	------------------	------------------	----------------------	---------------	---------------

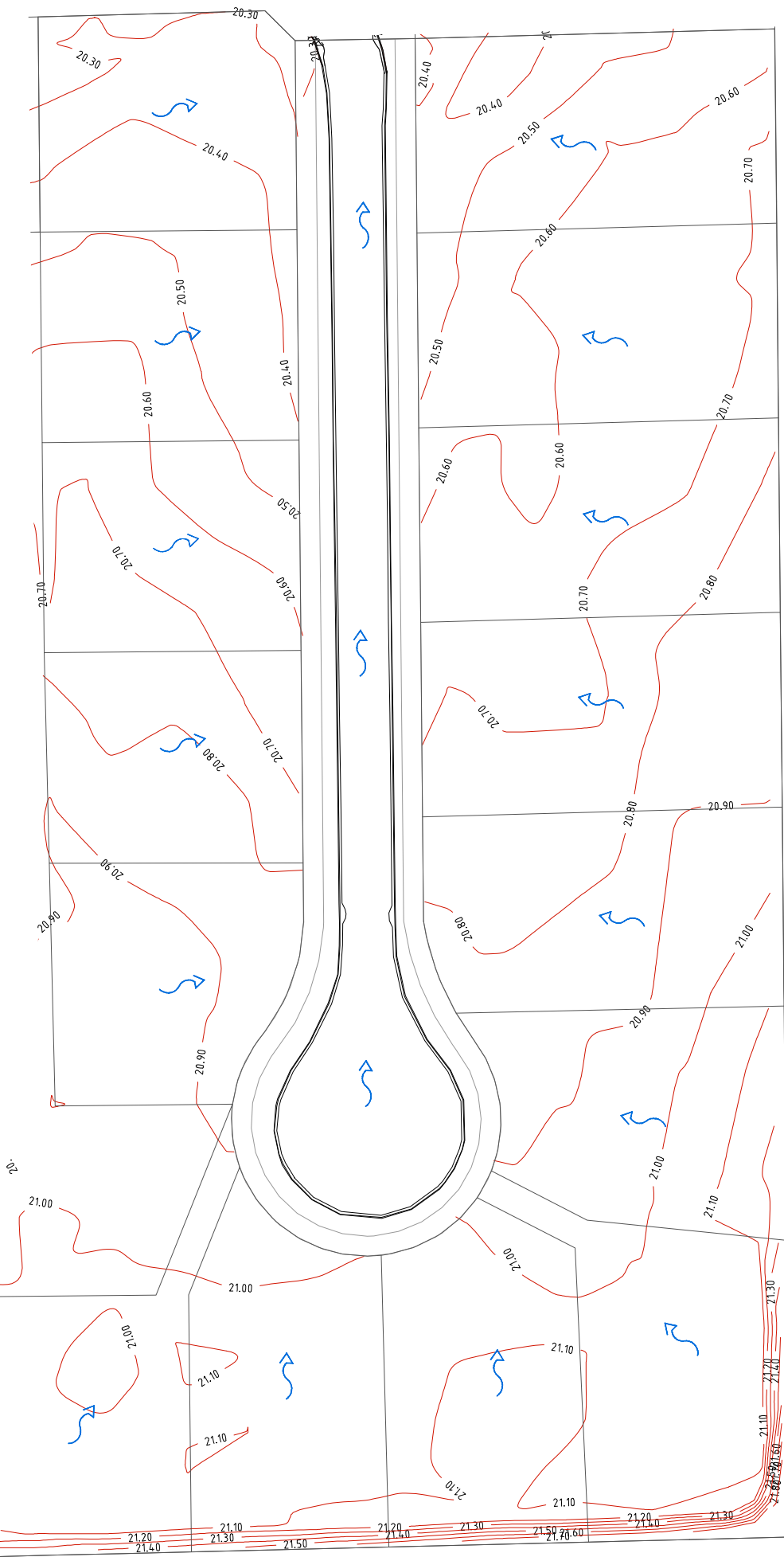

LEGEND:



OVERLAND FLOW PATH

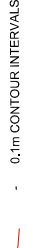

0.1m CONTOUR INTERVALS

<p>SAFETY IN DESIGN THE CONTRACTOR IS TO BE AWARE OF ALL INSPECTIONS TO BE MADE BY THE ENGINEER AS PER CONSTRUCTION REVIEW DOCUMENTATION AND TO BE COMPLETED PRIOR TO THE START OF WORK. NOTIFICATION WHEN ALL STRUCTURAL ELEMENTS ARE READY TO BE INSPECTED.</p>		<p>THE CONTRACTOR IS TO BE AWARE OF ALL INSPECTIONS TO BE MADE BY THE ENGINEER AS PER CONSTRUCTION REVIEW DOCUMENTATION AND TO BE COMPLETED PRIOR TO THE START OF WORK. NOTIFICATION WHEN ALL STRUCTURAL ELEMENTS ARE READY TO BE INSPECTED.</p>	
REV	REASON FOR ISSUE	DATE	BY
1	FOR CLARITY	23/03/2018	RB
<p>CLIENT: GREENSTONE LAND DEVELOPMENT LTD</p>			
<p>PROJECT: LYNDRHURST ARBUCKLE SUBDIVISION</p>			
<p>TITLE: CONTOUR PLAN AND OVERLAND FLOW STAGE 4</p>			
DESIGNED BY	CHECKED BY	DATE	SCALE
DR	RB	23/03/2018	1:200
<p>PROJECT NO: J4293</p>			
<p>REVISION: C001</p>			
<p>1</p>			
<p>This drawing and its contents are the property of Stratagroup Consulting Engineers Ltd. Any unauthorised reproduction or modification in full or part is prohibited.</p>			

stratagroup
 CONSULTING ENGINEERS
 P 08 807698
 1000 Otago Street East
 Dunedin, New Zealand
 www.stratagroup.co.nz
 Structural Firm
 Civil Project Management



LYNDHURST ROAD

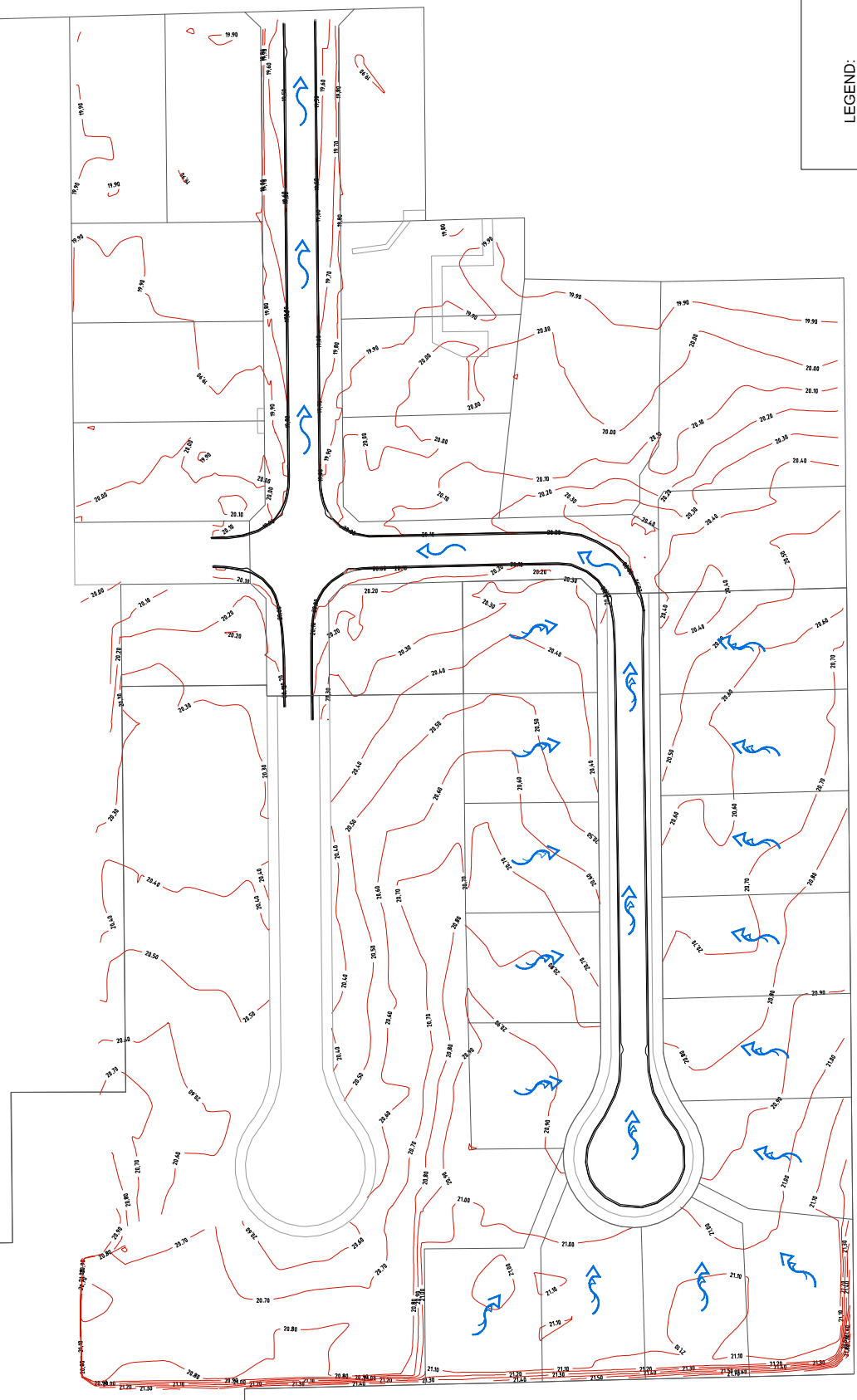

LEGEND:
- OVERLAND FLOW PATH
- 0.1m CONTOUR INTERVALS

REV	REASON FOR ISSUE	DATE	BY
1	FOR CLARITY	23/02/2018	PR

SAFETY IN DESIGN
 THE ENGINEER'S PROFESSIONAL DUTY IS TO ENSURE THAT THE DESIGN IS SAFE FOR THE PUBLIC AND THE OPERATOR OF THE FACILITY.
 THE ENGINEER HAS CONSIDERED THE SAFETY OF THE DESIGN AND HAS TAKEN THE NECESSARY PRECAUTIONS TO PROTECT THE SAFETY OF THE PUBLIC AND THE OPERATOR OF THE FACILITY.
 THE ENGINEER HAS CONSIDERED THE SAFETY OF THE DESIGN AND HAS TAKEN THE NECESSARY PRECAUTIONS TO PROTECT THE SAFETY OF THE PUBLIC AND THE OPERATOR OF THE FACILITY.
 THE ENGINEER HAS CONSIDERED THE SAFETY OF THE DESIGN AND HAS TAKEN THE NECESSARY PRECAUTIONS TO PROTECT THE SAFETY OF THE PUBLIC AND THE OPERATOR OF THE FACILITY.

stratagroup
 CONSULTING ENGINEERS
 P O BOX 7508
 10100 GARDEN ROAD
 BUSINESS 142
 MELBOURNE VIC 3002
 www.stratagroup.net.au
 Structural Free Civil Project Management

CLIENT
GREENSTONE LAND DEVELOPMENT LTD

PROJECT
LYNDHURST ARBUCKLE SUBDIVISION

TITLE
CONTOUR PLAN ENTIRE SITE STAGE 4

DESIGNED BY D.J.	CHECKED BY D.J.	DATE 20/02/2018	PROJECT NO. J4293	SHEET C002	REVISION 1
FULL SIZE 1:400; HALF SIZE 1:800 SCALE (M)			THIS DRAWING AND ITS CONTENTS ARE THE PROPERTY OF STRATAGROUP CONSULTING ENGINEERS LTD. ANY UNAUTHORIZED REPRODUCTION OR REPRODUCTION IN FULL OR PART IS PROHIBITED.		

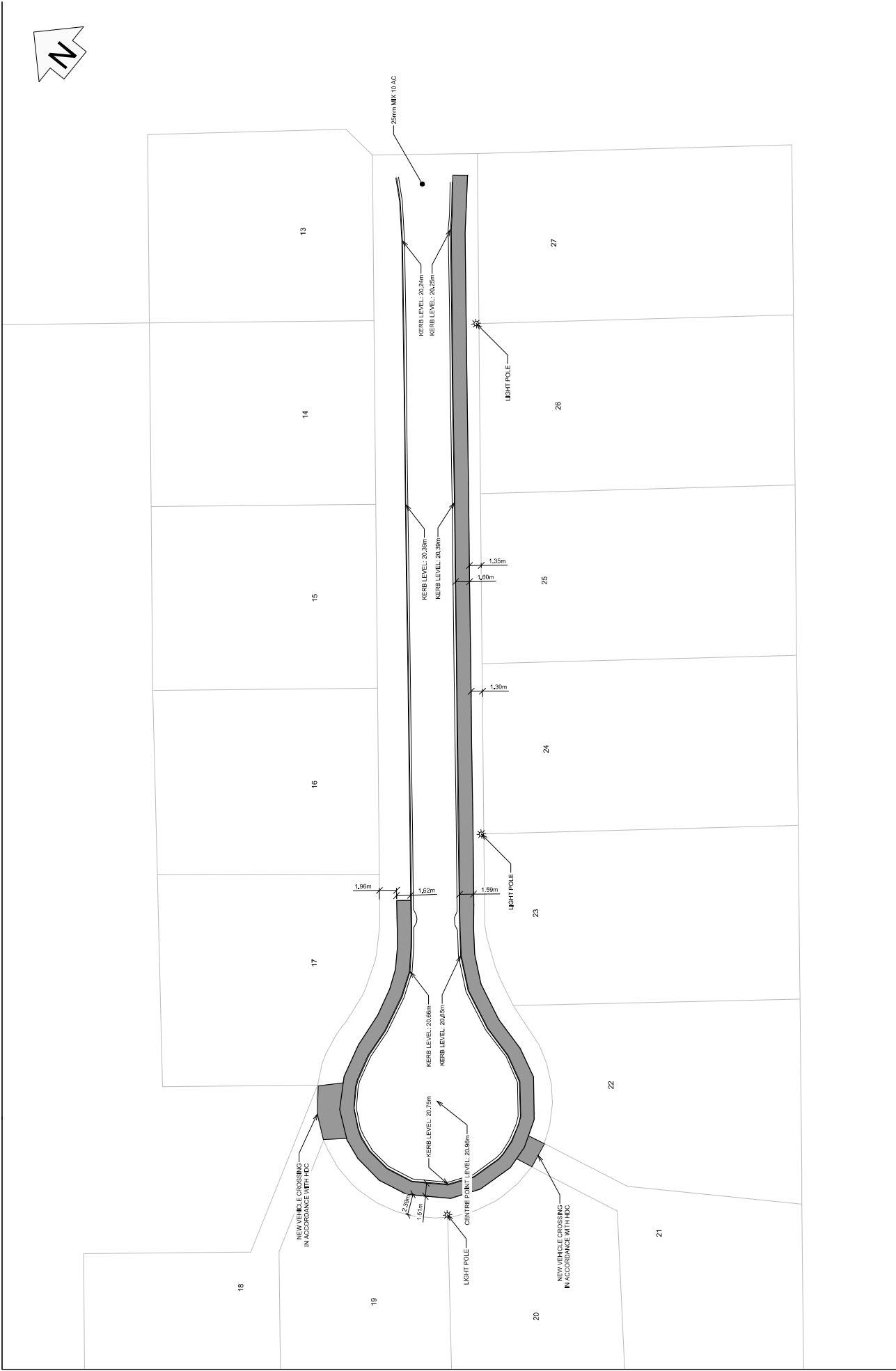

SAFETY IN DESIGN THE ENGINEER HAS CONSIDERED THE NEEDS OF ALL GROUPS OF WORK FOR THE DESIGN IN ACCORDANCE WITH THE REQUIREMENTS OF THE ENGINEERING ACT AND OTHER STRUCTURES (July 2002) IT REMAINS THE RESPONSIBILITY OF THE CLIENT AND CONTRACTOR TO ENSURE THAT ALL PRACTICES ARE IN PLACE TO PROTECT THE SAFETY OF WORKERS AND THE PUBLIC IN THE OPERATION OF THE FACILITY.		THE CONTRACTOR IS TO BE AWARE OF ALL INSTRUCTIONS TO BE MADE BY THE ENGINEER AS A REQUIREMENT OF THE ENGINEERING ACT AND THE ENGINEER WILL BE REQUIRED TO INSPECT ALL ELEMENTS ARE READY TO BE INSPECTED.		CLIENT GREENSTONE LAND DEVELOPMENT LTD CONSULTING ENGINEERS 70 BOX 718 1100 Claver Street East Auckland New Zealand Strataki - Fire Project Management	PROJECT LYNDHURST ARBUCKLE SUBDIVISION	TITLE FP & ROAD ASBUILT PLAN STAGE 4 <small>This drawing and its contents are the property of Strataki Consulting Engineers Ltd. Any unauthorised employment or reproduction in full or part is prohibited.</small>	DESIGNED BY: JZ CHECKED BY: JZ DATE: 20/2/218	FULL SCALE: 1:200 - HALF SCALE: 1:100 SCALE (m): J4293	SHEET: C003 REVISION:
REV	REASON FOR ISSUE	DATE	BY						

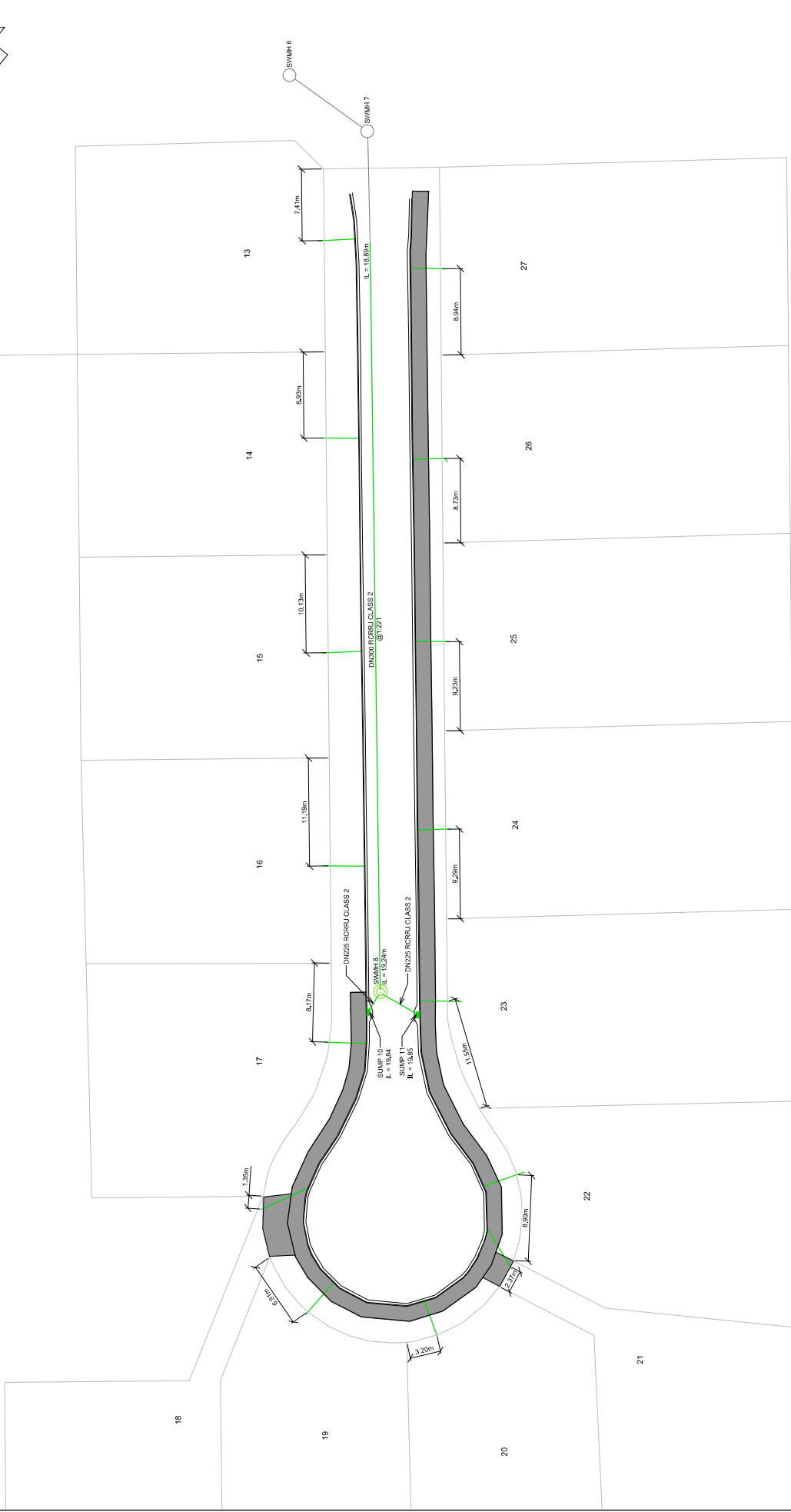

SAFETY IN DESIGN

THE ENGINEER HAS CONSIDERED THE WORKS TO BE CONSIDERED WITHIN STRATA GROUPS SCOPE OF WORK FOR THE DESIGN IN ACCORDANCE WITH THE STRATA MANAGEMENT ACT 2002. IT REMAINS THE RESPONSIBILITY OF THE STRATA GROUPS TO ENSURE THE DESIGN IS COMPLETED IN ACCORDANCE WITH THE STRATA MANAGEMENT ACT 2002. IT REMAINS THE RESPONSIBILITY OF THE STRATA GROUPS TO ENSURE THE DESIGN IS COMPLETED IN ACCORDANCE WITH THE STRATA MANAGEMENT ACT 2002.

REV	REASON FOR ISSUE	DATE	BY

THE CONTRACTOR IS TO BE AWARE OF ALL INSPECTIONS TO BE MADE BY THE ENGINEER AS A REQUIREMENT OF THE PRODUCER STATEMENT OF WORKS (PSOW) TO BOX 218. THE ENGINEER WILL BE REQUIRED TO BE PRESENT AT ALL INSPECTIONS. ALL ELEMENTS ARE READY TO BE INSPECTED.

stratagroup
CONSULTING ENGINEERS
10/380 Owen Street East
Stuarton QLD 4057
P 08 879 7668
F 08 879 7665
strata@stratagroup.com.au
Stratagroup Inc. Civil Project Management

CLIENT: GREENSTONE LAND DEVELOPMENT LTD
PROJECT: LYNDBURST ARBUCKLE SUBDIVISION
TITLE: STORMWATER ASBUILT PLAN STAGE 4

DESIGNED BY: JZ	CHECKED BY: JZ	DATE: 20/02/18
PROJECT NO: J4293	SHEET: C004	REVISION:
<small>The drawings are the property of Stratagroup Consulting Engineers Ltd. Any unauthorised employment or reproduction in full or part is prohibited.</small>		